

The **Boom TD** is used for transporting rolls, tubes or coils.

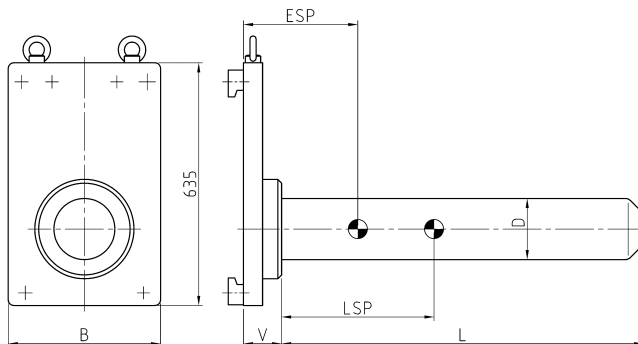

type	length L mm	diameter D mm	capacity kg/mm LSP (LC)					B mm	V LLC mm	ESP COG mm	weight kg	ISO
			500	600	800	1000	1500					
TD-60	1000	220	6000	5140	—	—	—	600	120	155	308	IV
TD-60	2000	220	6000	5140	4500	3400	—			477	395	IV
TD-60	3000	220	6000	5140	4500	3400	2750			850	490	IV
TD-80	1000	220	8000	6850	—	—	—	600	120	170	415	IV
TD-80	2000	220	8000	6850	6000	4570	—			495	535	IV
TD-80	3000	220	8000	6850	6000	4570	3690			884	655	IV
TD-120	1000	300	12000	10500	—	—	—	800	140	145	580	Pin-type
TD-120	2000	300	12000	10500	9300	7300	—			400	700	
TD-150	1000	360	15000	13210	—	—	—	800	160	135	760	Pin-type
TD-150	2000	360	15000	13210	11600	9100	—			408	926	
TD-200	1000	420	20000	17600	—	—	—	1000	160	140	1050	Pin-type
TD-200	2000	420	20000	17600	15700	12500	—			380	1247	

- length of the boom should be 70% of the length of the roll
- lengths of more than 4000 mm upon request
- quick release hooks upon request

